

# Coupling for HDPE Pipe

## STYLE 995



SEE VICTAULIC PUBLICATION 10.01 FOR DETAILS

Victaulic Style 995 HDPE couplings have sharp gripping teeth on both sides of the coupling which grip into the HDPE pipe around the circumference. As the housings are tightened pad-to-pad, the four bolts (two on 2"/50 mm sizes) force the teeth to engage into the pipe wall. This design permits direct joining of HDPE pipe without fusing equipment.

The 14 - 20"/350 - 500 mm sizes use a T-bolt (patent pending) which is designed to ease alignment of the bolt pad during assembly.

Couplings are supplied with plated carbon steel bolts and nuts and hardened steel washers. A choice of either U.S. imperial or ISO metric bolts and nuts is available. Clearly specify choice on order. For special conditions, Type 304 or Type 316 stainless steel bolts and nuts are available. Contact Victaulic for details.

For metric size HDPE pipe couplings request 19.05.

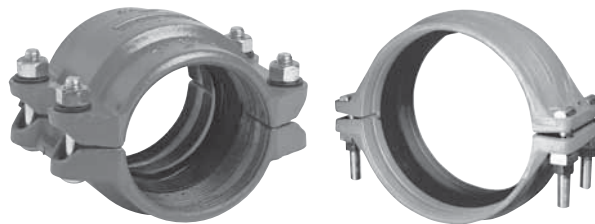

### DIMENSIONS

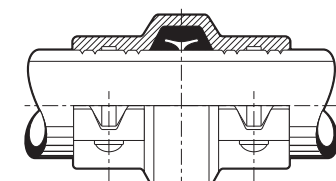
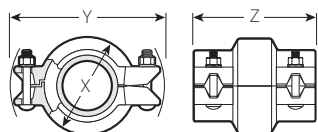

Exaggerated for clarity

3 - 12"/(80 - 300 MM SIZES  
(2"/50 MM HAS 1 BOLT PER SIDE)

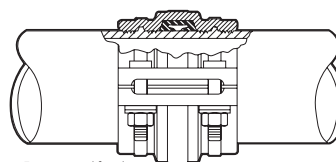
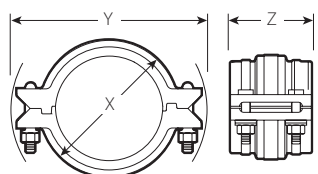

Exaggerated for clarity

14 - 20"/350 - 500 MM SIZES

Pipe Size		Coupling Dim. Inches/mm			Bolt/Nut No. - Size		Aprx. Wgt. Ea.
Nom. Dia. In./mm	Actual Out. Dia. In./mm	X	Y	Z	Inches	Lbs. kg	
2 50	2.375 60.3	3.69 94	5.94 151	3.63 92	2 - 1/2 x 2 1/2	3.5 1.6	
3 80	3.500 88.9	4.63 118	7.00 178	4.56 116	4 - 1/2 x 2 3/4	7.7 3.5	
90 †	90.9	116	178	116	M12 x 70 Lg.	3.4	
110 †	111.0	145	202	146	M12 x 70 Lg.	5.3	
4 100	4.500 114.3	5.88 149	8.13 207	5.81 148	4 - 1/2 x 23/4	11.6 5.3	
140 †	141.3	176	250	149	M16 x 83 Lg.	6.8	
5 125	5.563 141.3	6.94 176	9.88 251	5.88 149	4 - 5/8 x 31/4	15.0 6.8	
160 †	161.5	195	268	149	M16 x 83 Lg.	7.3	
6 150	6.625 168.3	8.00 203	10.88 276	5.88 149	4 - 5/8 x 31/4	16.4 7.4	
200 †	201.8	259	336	152	M16 x 83 Lg.	9.7	
225 †	227.1	265	345	152	M16 x 83 Lg.	10.9	
8 200	8.625 219.1	10.19 259	13.25 337	6.00 152	4 - 5/8 x 31/4	24.9 11.3	
250 †	252.3	314	402	165	M20 x 127 Lg.	17.0	

Pipe Size		Coupling Dim. Inches/mm			Bolt/Nut No. - Size		Aprx. Wgt. Ea.
Nom. Dia. In./mm	Actual Out. Dia. In./mm	X	Y	Z	Inches	Lbs. kg	
10 250	10.750 273.0	12.38 314	15.88 403	6.50 165	4 - 3/4 x 5	37.4 17.0	
280 †	282.6	321	408	165	M20 x 127 Lg.	17.6	
315 †	317.9	356	448	178	M22 x 127 Lg.	20.7	
12 300	12.750 323.9	14.38 365	18.00 457	7.00 178	4 - 7/8 x 5	49.0 22.2	
355 †	358.2	414	525	218	M24 x 178 Lg.	36.7	
14 350	14.000 355.6	16.25 413	19.88 505	8.58 218	4 - 1 x 7 §	81.0 36.7	
400 †	403.6	465	605	229	M24 x 178 Lg.	45.5	
16 400	16.000 406.4	18.30 465	23.88 607	9.00 229	4 - 1 x 7 §	100.0 45.5	
450 †	453.8	516	650	241	M24 x 178 Lg.	57.7	
18 450	18.000 457.0	20.30 516	25.63 651	9.50 241	4 - 1 x 7 §	127.0 57.7	
500 †	504.0	566	699	254	M24 x 178 Lg.	64.5	
20 500	20.000 508.0	22.30 566	27.44 697	10.00 254	4 - 1 x 7 §	142.0 64.5	

§ Supplied with T-bolts and rocker washers (patent pending).

† Available in metric sizes only.

### JOB OWNER

System No. \_\_\_\_\_

Location \_\_\_\_\_

### CONTRACTOR

Submitted By \_\_\_\_\_

Date \_\_\_\_\_

### ENGINEER

Spec Sect \_\_\_\_\_ Para \_\_\_\_\_

Approved \_\_\_\_\_

Date \_\_\_\_\_

## Coupling for HDPE Pipe

STYLE 995



APPROVED

SEE VICTAULIC PUBLICATION 10.01 FOR DETAILS

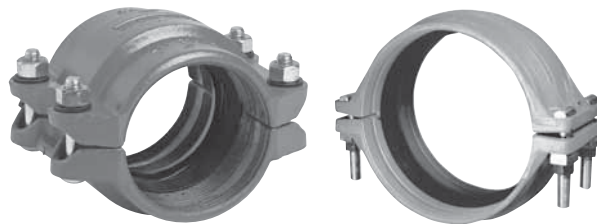

### PERFORMANCE

#### ⚠ CAUTION

- Victaulic Style 995 products are qualified for use on HDPE ONLY. These products should not be used on other plastic materials.
- Failure to follow this instruction could result in personal injury, improper installation, leakage or joint separation.

Always refer to Victaulic I-900 instruction handbook before assembly.

Victaulic HDPE products are designed to mechanically join HDPE (\*high density polyethylene/polybutylene conforming to ASTM D-2447, D-3000, D-3035 or F-714, at ambient temperatures) pipe of wall thicknesses from SDR 32.5 to 7.3. Victaulic HDPE products have integral rows of gripping teeth in each side of the housing which bite into HDPE pipe around the entire circumference. This eliminates special heat fusion, solvent joining or special adapters.

**Victaulic HDPE products are not intended for use on PVC pipe or other materials.** Victaulic lubricant should **not** be used with HDPE pipe.

HDPE pipe brands we have tested indicate that the working pressure of Victaulic HDPE products are dictated by the working pressure of the pipe. The pipe manufacturers listing is dependent upon wall thicknesses, pipe composition and temperature. Pipe tolerances shown in the charts are \*at +70°F (+21°C) and for rigid pipe with SDR of 20 or lower.

\*At ambient temperatures.

Pipe – In./mm		Dimensions – In./mm			Pipe – In./mm		Dimensions – In./mm		
Nom. Dia.	Act. Out. Dia.	Outside Dia. Size	Tol. *	Max. Out of Round Tol.*	Nom. Dia.	Act. Out. Dia.	Outside Dia. Size	Tol. *	Max. Out of Round Tol.*
2	2.375	2.375	± 0.016	± 0.040	10	10.750	10.750	± 0.048	± 0.075
50	60.3	60.3	0.406	1.016	250	273.0	273.0	1.219	1.905
3	3.500	3.500	± 0.016	± 0.040	12	12.750	12.750	± 0.057	± 0.075
80	88.9	88.9	0.406	1.016	300	323.9	323.9	1.448	1.905
4	4.500	4.500	± 0.020	± 0.040	14	14.000	14.000	± 0.063	± 0.075
100	114.3	114.3	0.508	1.016	350	355.6	355.6	1.600	1.905
5	5.563	5.563	± 0.025	± 0.050	16	16.000	16.000	± 0.072	§
125	141.3	141.3	0.635	1.270	400	406.4	406.4	1.830	§
6	6.625	6.625	± 0.030	± 0.050	18	18.000	18.000	± 0.081	§
150	168.3	168.3	0.762	1.270	450	457.2	457.2	2.060	§
8	8.625	8.625	± 0.039	± 0.075	20	20.000	20.000	± 0.090	§
200	219.1	219.1	0.990	1.905	500	508.0	508.0	2.290	§

\*At ambient temperatures.

§ See pipe manufacturer for maximum out of round tolerance.

## Coupling for HDPE Pipe

STYLE 995



SEE VICTAULIC PUBLICATION 10.01 FOR DETAILS

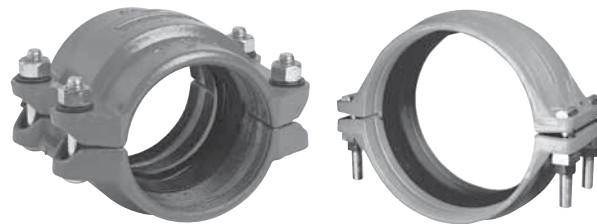

### MATERIAL SPECIFICATIONS

**Housing:** Ductile iron conforming to ASTM A-395, grade 65-45-15, and ASTM A-536, grade 65-45-12.

**Housing Coating:** Orange enamel

- **Optional:** Hot dip galvanized
- **Optional:** Zinc electroplated

**Gasket:** (specify choice\*)

- **Grade "E" EPDM**

EPDM (Green color code). Temperature range  $-30^{\circ}\text{F}$  to  $+230^{\circ}\text{F}$ / $-34^{\circ}\text{C}$  to  $+110^{\circ}\text{C}$ . Recommended for cold and hot water service within the specified temperature range plus a variety of dilute acids, oil-free air and many chemical services. UL classified in accordance with ANSI/NSF 61 for cold  $+86^{\circ}\text{F}/+30^{\circ}\text{C}$  and hot  $+180^{\circ}\text{F}/+82^{\circ}\text{C}$  potable water service. NOT RECOMMENDED FOR PETROLEUM SERVICES.

- **Grade "T" nitrile**

Nitrile (Orange color code). Temperature range  $-20^{\circ}\text{F}$  to  $+180^{\circ}\text{F}$ / $-29^{\circ}\text{C}$  to  $+82^{\circ}\text{C}$ . Recommended for petroleum products, air with oil vapors, vegetable and mineral oils within the specified temperature range. Not recommended for hot water services over  $+150^{\circ}\text{F}/+66^{\circ}\text{C}$  or for hot dry air over  $+140^{\circ}\text{F}/+60^{\circ}\text{C}$ .

\*Services listed are General Service Recommendations only. It should be noted that there are services for which these gaskets are not recommended. Reference should always be made to the latest Victaulic Gasket Selection Guide for specific gasket service recommendations and for a listing of services which are not recommended.

**Bolts/Nuts/Washers:** Heat treated carbon steel, plated, track-head conforming to physical properties of ASTM A-183 minimum tensile 110,000 psi/758340 kPa.

The 2 - 12"/50 - 300 mm sizes are supplied with hardened steel washers meeting ASTM F-436 Type 3 (weathering steel).

The 14 - 20"/350 - 500 mm sizes are supplied with a T-bolt (patent pending) assembly. Contact Victaulic for details.

- **Optional:** Type 304 or 316 stainless steel.

# Coupling for HDPE Pipe

STYLE 995



APPROVED

SEE VICTAULIC PUBLICATION 10.01 FOR DETAILS

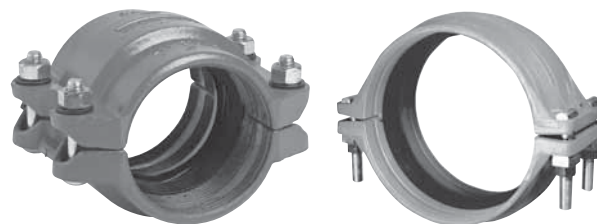

## WARRANTY

Refer to the Warranty section of the current Price List or contact Victaulic for details.

## NOTE

This product shall be manufactured by Victaulic or to Victaulic specifications. All products to be installed in accordance with current Victaulic installation/assembly instructions. Victaulic reserves the right to change product specifications, designs and standard equipment without notice and without incurring obligations.

### US & WORLD HEADQUARTERS

P.O. Box 31  
Easton, PA 18044-0031 USA

4901 Kesslersville Road  
Easton, PA 18040 USA

1-800-PICK-VIC (1-800-742-5842)  
1-610-559-3300  
1-610-250-8817 (fax)  
pickvic@victaulic.com

[www.victaulic.com](http://www.victaulic.com)

### CANADA

905-884-7444  
905-884-9774 (fax)  
viccanada@victaulic.com

### EUROPE

32-9-381-15-00  
32-9-380-44-38 (fax)  
viceuro@victaulic.be

### UNITED KINGDOM

44 (0) 1438741100  
44 (0) 1438313883 (fax)  
viceuro@victaulic.be

### CENTRAL AND SOUTH AMERICA

1-610-559-3300  
1-610-559-3608 (fax)  
vical@victaulic.com

### ASIA PACIFIC

86-21-54253300  
86-21-54253671 (fax)  
vicap@victaulic.com

### MIDDLE EAST

971-4-883-88-70  
971-4-883-88-60 (fax)



WCAS-6LUPPP