

**Geberit Mapress adapter with female thread**

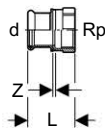

**Application Purpose**

- For sanitary and industrial applications
- For heating installations

**Characteristics**

- Female thread
- Leaky if unpressed
- With pressing indicator

**Product Details**

Product material	CrNiMo steel 1.4401 (DIN EN 10088)
------------------	------------------------------------

**Scope Of Delivery**

- Seal ring CIIR black

**Ordering Information**

Article no.		dØ [mm]	Rp ["]	L [cm]	Z [cm]
31801	new	15	3/8	3,5	0,5
31802		15	1/2	3,7	0,4
31823		15	3/4	3,8	0,3
31803		18	1/2	3,7	0,4
31804		18	3/4	3,8	0,3
31805		22	1/2	3,6	0,2
31806		22	3/4	3,9	0,3
31824		22	1	4,2	0,4
31807		28	1/2	3,8	0,2
31819		28	3/4	3,9	0,3
31809		28	1	4,4	0,4
31825		28	1 1/4	4,6	0,4
31820		35	1	4,5	0,2
31811		35	1 1/4	4,9	0,4
31826		35	1 1/2	4,9	0,4
31821		42	1 1/4	5,1	0,2
31814		42	1 1/2	5,3	0,4
31822		54	1 1/2	7,1	2,2
31818		54	2	6,2	0,4

**Geberit Mapress adapter with female thread and plain end**

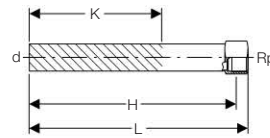
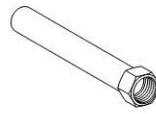

**Application Purpose**

- For sanitary and industrial applications
- For heating installations

**Characteristics**

- Female thread
- Plain end

**Product Details**

Product material	CrNiMo steel 1.4401 (DIN EN 10088)
------------------	------------------------------------

**Ordering Information**

Article no.	dØ [mm]	Rp ["]	H [cm]	L [cm]	K [cm]
90932	15	1/2	13,5	14,8	9
90933	18	1/2	13,5	14,8	9
90934	18	3/4	13,3	15,2	9
90935	22	1/2	13,9	14,8	8,9
90936	22	3/4	13,7	15,2	8,7

**Elbow adapters**

**Geberit Mapress elbow adapter 90° with male thread**

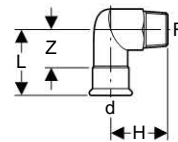

**Application Purpose**

- For sanitary and industrial applications
- For heating installations

**Characteristics**

- Male thread
- Leaky if unpressed
- With pressing indicator

**Product Details**

Product material	CrNiMo steel 1.4401 (DIN EN 10088)
Elbow	90°

**Scope Of Delivery**

- Seal ring CIIR black

**Ordering Information**

Article no.	dØ [mm]	R ["]	H [cm]	L [cm]	Z [cm]
33833	15	1/2	3,7	5,7	3,7
33834	18	1/2	3,9	5,7	3,7
33835	22	3/4	4,6	6	3,9
33836	28	1	5,4	6,7	4,4
33837	35	1 1/4	6,3	7,5	4,9
33838	42	1 1/2	6,7	8,3	5,3
33839	54	2	7,8	9,4	5,9

