

KÜRESEL VANALAR - BALL VALVES

Malzemeler / Materials

Gövde / Body : CW617N - EN 12165 Krom kaplı piriñ / hot-pressed brass, chrome plated
 Kapak / Sleeve : CW617N - EN 12165 Krom kaplı piriñ / hot-pressed brass, chrome plated
 Mil / Stem : CW614N - EN 12164 Piriñ, sörtürmeyi önleyen ve sızdırmazlık riñgleri ile /
 bar turned brass, with inner and outer anti-friction rings and double sealing O-ring
 Küre / Ball : CW617N Krom kaplı piriñ / brass, chrome plated
 Conta / Gaskets : Düşük sörtürme profilili teflon / PTFE with low friction profile
 Kol / Handle : Plastik kaplı çelik / steel lever with plasticized coating
 Somun / Nut : Korozyon dayanımlı kaplama, garanti mühürü ve hologramlı / with anti-
 corrosion coating, guarantee seal and hologram

Uygulama Alanları / Field of application

Su için maks. çalışma basıncı / Max. working pressure with water: 4,2 MPa (42 bar), from 1/2" to 3/4"
 3,5 MPa (35 bar), from 1" to 2"
 Maks. çalışma sıcaklığı / Max. operating working temperature: 120°C

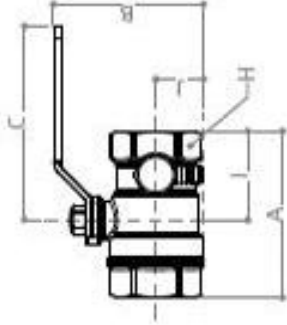

ITEM	SIZE	DN	A	I	B	J	C	H
R250DS	1/2"	14	59	32	48	15	77	25
	3/4"	18	69	36	64	18	94	32
	1"	22	81	43	73	23	94	39
	1 1/4"	28	99	57	82	28	94	48
	1 1/2"	35	107	60	100	33	136	55
	2"	45	121	67	115	41	136	67

Malzemeler / Materials

Gövde / Body : CW617N - EN 12165 Krom kaplı piriñ / hot-pressed brass, chrome plated
 Kapak / Sleeve : CW617N - EN 12165 Krom kaplı piriñ / hot-pressed brass, chrome plated
 Mil / Stem : CW614N - EN 12164 Piriñ, sörtürmeyi önleyen ve sızdırmazlık riñgleri ile /
 bar turned brass, with inner and outer anti-friction rings and double sealing O-ring
 Küre / Ball : CW617N brass, chrome plated / Krom kaplı piriñ
 Conta / Gaskets : Düşük sörtürme profilili teflon / PTFE with low friction profile
 Kol / Handle : Plastik kaplı çelik / steel lever with plasticized coating
 Somun / Nut : Korozyon dayanımlı kaplama, garanti mühürü ve hologramlı / with anti-
 corrosion coating, guarantee seal and hologram

Uygulama Alanları / Field of application

Su için maks. çalışma basıncı / Max. working pressure with water: 4,2 MPa (42 bar), from 1/2" to 3/4"
 3,5 MPa (35 bar), from 1" to 2"
 Maks. çalışma sıcaklığı / Max. operating working temperature: 120°C

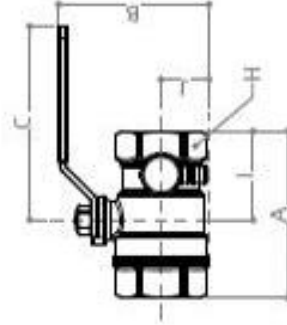

ITEM	SIZE	DN	A	I	B	J	C	H
R250WS	1/2"	14	60	32	48	15	77	25
	3/4"	18	71	36	64	18	94	32
	1"	22	83	43	73	23	94	39
	1 1/4"	28	102	56	82	28	94	48
	1 1/2"	35	110	60	100	33	136	55
	2"	45	128	67	115	41	136	67