

FireLock® Low-Profile Sprinkler-Tee



SEE VICTAULIC PUBLICATION 10.01 FOR DETAILS

STYLE 912

The Style 912 Low-Profile Sprinkler-tee provides a 1/2" outlet for connecting sprinklers directly, to 1", 1-1/4", and 1-1/2" piping systems. The Style 912 outlet-tee is suitable for use on standard, light-wall, and other specialty pipes.*

During installation, the locating collar engages the pre-cut pipe-hole, and when tightened, the gasket is compressed onto the O.D. of the pipe forming a leak-free seal.

The Style 912 Sprinkler-tee is FM approved for wet and dry sprinkler connections to 300 psi/2058kPa, and VdS and LPCB approved to 232 psi/16bar, at ambient temperature.



MATERIAL SPECIFICATIONS

Housing: Ductile iron conforming to ASTM A-536, grade 65-45-12. Ductile iron conforming to ASTM A-395, grade 65-45-15, is available upon special request.

Housing Coating:

- Red enamel or hot-dipped galvanized

Gasket:

- Grade "E" EPDM - Type A

(Violet color code). FireLock products have been Listed by Underwriters Laboratories Inc. and Approved by Factory Mutual Research for wet and dry (oil free air) sprinkler services up to the rated working pressure using the Grade "E" Type A Gasket System.

Bolts/Nuts: Heat-treated plated carbon steel, trackhead meeting the physical and chemical requirements of ASTM A-449 and physical requirements of ASTM A-183.

JOB/OWNER

System No. _____

Location _____

CONTRACTOR

Submitted By _____

Date _____

ENGINEER

Spec Sect _____ Para _____

Approved _____

Date _____

www.victaulic.com

VICTAULIC IS A REGISTERED TRADEMARK OF VICTAULIC COMPANY. © 2009 VICTAULIC COMPANY. ALL RIGHTS RESERVED.

REV_C



FireLock® Low-Profile Sprinkler-Tee

STYLE 912

DIMENSIONS

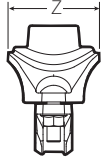
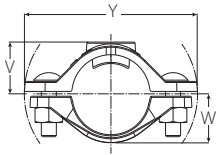

Nominal Size (inches) Actual (mm)		Hole Diameter					Approximate Weight Each
Run x Branch FPT†		+0.06/+1,5 -0.00/-0,0	V	W	Y	Z	lbs/kg
1 33.7	x ½ 21.3	⅝ 24.0	1.00 25.4	0.90 22.9	3.72 94.6	1.50 38.1	0.67 0.30
1¼ 42.4	x ½ 21.3	⅝ 24.0	1.17 29.8	1.10 27.9	4.12 104.7	1.50 38.1	0.74 0.33
1½ 48.3	x ½ 21.3	⅝ 24.0	1.29 32.8	1.22 31.0	4.32 109.8	1.50 38.1	0.76 0.34

† Victaulic female threaded products are designed to accommodate standard NPT or BSPT (optional) male pipe threads only. Use of male threaded products with special features, such as probes, dry pendent sprinklers, etc., should be verified as suitable for use with this Victaulic product. Failure to verify suitability in advance may result in assembly problems or leakage.

*Center of run to engaged pipe end for NPT threads (dimensions are approximate).

INSTALLATION

Reference should always be made to the I-100 Victaulic Field Installation Handbook for the product you are installing. Handbooks are included with each shipment of Victaulic products for complete installation and assembly data, and are available in PDF format on our website at www.victaulic.com.

WARRANTY

Refer to the Warranty section of the current Price List or contact Victaulic for details.

NOTE

This product shall be manufactured by Victaulic or to Victaulic specifications. All products to be installed in accordance with current Victaulic installation/assembly instructions. Victaulic reserves the right to change product specifications, designs and standard equipment without notice and without incurring obligations.

For complete contact information, visit www.victaulic.com

10.53 5516 REV C UPDATED 4/2009

VICTAULIC IS A REGISTERED TRADEMARK OF VICTAULIC COMPANY. © 2009 VICTAULIC COMPANY. ALL RIGHTS RESERVED.

10.53

